



T719AA Series

Abrasive Slurry S&D Hose
with Field Attachable Coupling System



T719AA Series
Abrasive Slurry Hose

ALFAMUFF Series
Field Attachable Coupling



Excellent for highly abrasive applications such as coal, stone and ore.



KURIYAMA
OF AMERICA, INC.

NEW

T719AA Series

Abrasive Slurry S&D Hose



VIEW ONLINE



SCAN FOR INFO

or visit

KOA.link/T719AA

GENERAL APPLICATIONS

- Mining Industry (crushed/ground ore, washed coal and waste products)
- Rock quarries (crushed/ground ore, sand and river stone)
- Cement industry (lime, stone and other slurries)

CONSTRUCTION

Tube: Black conductive NR-abrasion resistance 50 mm³.

Reinforcement: High tensile textile cords with embedded steel helical wire.

Cover: Corrugated black conductive CR-abrasion, ozone, seawater and hydrocarbon resistant.

SERVICE TEMPERATURE RANGE

-22°F (-30°C) to +176°F (+80°C)

BRANDING

ALFAGOMMA ITALY 719 10 bar (150 psi) BULK MATERIAL HANDLING S&D Ω (in white letters)

FEATURES AND ADVANTAGES

- **Abrasive Resistant Tube** – Thick, highly abrasion resistant natural rubber (NR) tube. Designed to handle highly abrasive materials such as coal, sand and stone.
- **Heavy Duty Construction** – High tensile cords with embedded steel wire helix designed for applications where the hose will be subject to abuse. Its chloroprene cover resists weathering, ozone, hydrocarbons and seawater.
- **Corrugated Outer Cover** – Corrugated outer cover provides additional flexibility versus smooth cover hoses.
- **Conductive Materials** – Conductive tube and cover materials dissipate static in potentially explosive environments.

Part Number	ID		OD		Tube Thickness		Max Rec. WP (psi)	Vacuum Hg (in)	Min. Bending Radius at 68°F (in)	Standard Length (ft)	Weight (lbs/ft)
	(in)	(mm)	(in)	(mm)	(in)	(mm)					
T719AA200X100	2	51	2.95	75	0.236	6	150	30	10	100	2.09
T719AA300X100	3	76	4.49	114	0.354	9	150	30	15	100	4.96
T719AA400X100	4	102	5.24	133	0.315	8	150	30	20	100	5.25
T719AA600X100	6	152	7.40	188	0.315	8	150	30	30	100	9.53
T719AA800X100	8	203	9.57	243	0.315	8	150	30	48	100	12.53
T719AA1000X40	10	254	11.57	294	0.315	8	150	30	80	40	15.70
T719AA1200X40	12	305	13.94	354	0.354	9	150	30	96	40	19.41

Also available in 2 1/2" and 5" sizes upon request subject to minimum order quantities and lead times. Contact Kuriyama for more information.

Because we continually examine ways to improve our products, we reserve the right to alter specifications or discontinue products without prior notice.

NEW



ALFAMUFF Series

Field Replaceable Fixed Flange-Muff Coupling

GENERAL APPLICATIONS

Specially designed for use with the T719AA abrasive slurry hose.

FEATURES AND ADVANTAGES

- **Easy Assembly** – Two identical half shells connected with bolts (included) can be assembled in the field.*
- **Reduces Replacement Costs** – Re-usable and durable couplings since not in contact with transported abrasive materials.
- **Lightweight and Durable** – Aluminum lightweight-flanged connection system.
- **Compatibility** – Universal flanges with elliptical drilling patterns.

* Coupling complete with bolts, nuts and washers.

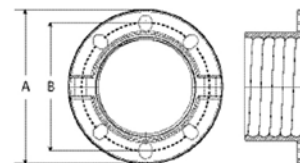

VIEW ONLINE



SCAN FOR INFO

or visit

KOA.link/ALFAMUFF

Part Number	ID		Length		Max. Rec. WP (psi)	Thread Type	Flange Compatibility	Flange Dimensions				Weight Each (lbs)
	(in)	(mm)	(in)	(mm)				A (in)	A (mm)	B (in)	B (mm)	
ALFAMUFF200	2	51	3.35	85	150	UNIV	PN10/ASA150/TAB.D-E	6.50	165	4.72	120	3.15
ALFAMUFF300	3	76	3.35	85	150	UNIV	PN10/ASA150/TAB.D-E	7.87	200	6.06	154	3.73
ALFAMUFF400	4	102	3.35	85	150	UNIV	PN10/ASA150/TAB.D-E	9.05	230	7.16	182	4.71
ALFAMUFF600	6	152	4.53	115	150	UNIV	PN10/ASA150/TAB.D-E	11.22	285	9.29	236	8.34
ALFAMUFF800	8	203	5.90	150	150	UNIV	PN10/ASA150/TAB.D-E	13.58	345	11.50	292	13.26
ALFAMUFF1000	10	254	6.89	175	150	UNIV	PN10/ASA150/TAB.E	15.94	405	13.90	353	21.06
ALFAMUFF1200	12	305	7.68	195	150	UNIV	PN10/ASA150/TAB.D-E	19.49	495	16.46	418	30.23

10" size compatible with table E only

AVAILABLE Q1 2024



ALFASEAL Series

Flange Seal for Alfamuff Couplings

GENERAL APPLICATIONS

Black SBR flange seal with elliptical drilling patterns compatible with the Alfamuff couplings.

VIEW ONLINE



SCAN FOR INFO

or visit

KOA.link/ALFASEAL

Part Number	ID		Thickness (mm)	Weight Each (lbs)
	(in)	(mm)		
ALFASEAL200	2	51	8	0.37
ALFASEAL300	3	76	8	0.54
ALFASEAL400	4	102	8	0.69
ALFASEAL600	6	152	8	0.95

Part Number	ID		Thickness (mm)	Weight Each (lbs)
	(in)	(mm)		
ALFASEAL800	8	203	8	1.30
ALFASEAL1000	10	254	8	1.60
ALFASEAL1200	12	305	8	2.46

Because we continually examine ways to improve our products, we reserve the right to alter specifications or discontinue products without prior notice.

Assembly Process



- 1** Measure and mark the hose to the required length



- 2** Cut the hose with a sharp cutting tool up to the steel helix wire



- 3** Cut the steel helix wire. The wire must not protrude past the end of the hose



- 4** Place the two half shells onto the hose and tighten the side flange bolts. The corrugation inside the muff coupling must align exactly with the corrugation of the hose cover



- 5** Cut off excess hose protruding past the coupling face



- 6** The hose assembly is now ready



Because we continually examine ways to improve our products, we reserve the right to alter specifications or discontinue products without prior notice.

The Alfagomma T719AA Abrasive Slurry Handling System

Consisting of the highly abrasion resistant T719AA Series, natural rubber lined hose, and the field attachable, aluminum alloy, ALFAMUFF Series coupling, the system provides convenience in assembly and repair in highly abrasive material transfer applications such as coal, sand and stone with no crimping required.

It's ALFAMUFF Series coupling is designed so that it does not come into contact with the abrasive transferred materials, extending its life, potentially allowing for use with other hoses. Its split flange design is connected by a series of bolts, providing a secure connection which can be done in the field without the need for crimping.

COST EFFECTIVE CONVENIENCE FOR ABRASIVE SLURRY APPLICATIONS

✓ Cut and Assemble on Site

The ability to cut to size and assemble on site reduces:

- Inventory costs
- Assembly costs
- Delivery lead times

✓ Reduce Replacement Costs

The reusable couplings reduce replacement costs.

✓ Long Hose Life

The wear resistant tube increases the hose lifespan.

PRIMARY APPLICATIONS

Material transportation in the following industries

MINING –

- Crushed and ground ore
- Washed coal
- Waste products
- Slurry

QUARRYING –

- Sand and river stone
- Crushed and ground ore
- Dry gravel

CEMENT –

- Lime
- Stone
- Slurry

ALUMINUM, STEEL, AND SMELTER –

- Dry powders and solids through abrasive lines
- Slurries
- Heavy-duty water slurries

Because we continually examine ways to improve our products, we reserve the right to alter specifications or discontinue products without prior notice.

Cautionary Statement

All Products sold and distributed by Kuriyama of America, Inc. are in the nature of commodities and they are sold by published specifications and not for particular purposes, uses or applications. Purchaser shall first determine their suitability for the intended purposes, uses or applications and shall either conduct its own engineering studies or tests, or retain qualified engineers, consultants or testing laboratories and consult with them before determining the proper use, suitability or propriety of the merchandise or Products for the intended purposes, uses or applications.

Kuriyama of America, Inc. ("Seller") does not recommend the Products for any particular purpose, use or application, and the Purchaser or user thereof shall assume full responsibility for the suitability, propriety, use and application of the Products. Purchaser shall follow all instructions contained in Seller's catalogs, brochures, technical bulletins and other documents regarding the Products. The Products, including but not limited to, hose, tubing or couplings, may fail due to the use or conveyance of substances at elevated or lowered temperatures or at excessive pressure, the conveyance of abrasive, injurious, flammable, explosive or damaging substances.

Hose or tubing used in bent configurations will be subjected to increased abrasion. Hose clamps or couplings may loosen after initial installation and all sections of hose and tubing including connections, couplings, clamps, conductivity and bonding should be inspected frequently, regularly and consistently, and should be replaced, adjusted or re-tightened for the avoidance of leakage, for the prevention of injuries or damages, and for general safety purposes. Except as indicated in its Limited Warranty, Seller shall not be liable or responsible for direct or indirect injuries or damages caused by or attributed to the failure or malfunction of any Products sold or distributed by it.

Purchasers or users of the Products should frequently and consistently undertake inspections and protective measures with respect to the use and application of Products, which should include the examination of tube and cover, conditions of the hose or tubing, and the identification, repair or replacement of sections showing cracking, blistering, separations, internal and external abrasions, leaking or slipped couplings or connections and make proper proof tests.

Limited Warranty

The Products sold or distributed by Seller are warranted to its customers to be free from defects in material and workmanship at the time of shipment by us, subject to the following provisions. ALL WARRANTY CLAIMS SHALL BE MADE WITHIN SIX (6) MONTHS AFTER SELLER SHIPPED THE PRODUCTS. SELLER'S LIABILITY HEREUNDER IS LIMITED AT SELLER'S EXCLUSIVE DISCRETION, TO 1) THE PURCHASE PRICE OF ANY PRODUCTS PROVING DEFECTIVE; 2) REPAIR OF ANY DEFECTIVE PRODUCT OR PART THEREOF; OR 3) REPLACEMENT OF ANY DEFECTIVE PRODUCT OR PART UPON ITS AUTHORIZED RETURN TO SELLER.

THIS WARRANTY IS IN LIEU OF AND EXCLUDES ALL OTHER WARRANTIES, EXPRESSED, IMPLIED, STATUTORY, OR OTHERWISE CREATED UNDER APPLICABLE LAW INCLUDING, BUT NOT LIMITED TO, THE WARRANTY OF MERCHANTABILITY AND THE WARRANTY OF FITNESS FOR A PARTICULAR PURPOSE. IN NO EVENT SHALL SELLER OR THE MANUFACTURER OF THE PRODUCT BE LIABLE FOR SPECIAL, INCIDENTAL, OR CONSEQUENTIAL DAMAGES, INCLUDING LOSS OF PROFITS, WHETHER OR NOT CAUSED BY OR RESULTING FROM THE NEGLIGENCE OF SELLER AND/OR THE MANUFACTURER OF THE PRODUCT, UNLESS SPECIFICALLY PROVIDED HEREIN. IN ADDITION, THIS WARRANTY SHALL NOT APPLY TO ANY PRODUCTS OR PORTIONS THEREOF WHICH HAVE BEEN SUBJECTED TO ABUSE, MISUSE, IMPROPER INSTALLATION, MAINTENANCE, OR OPERATION, ELECTRICAL FAILURE OR ABNORMAL CONDITIONS, AND TO PRODUCTS WHICH HAVE BEEN TAMPERED WITH, ALTERED, MODIFIED, REPAIRED, REWORKED BY ANYONE NOT APPROVED BY SELLER, OR USED IN ANY MANNER INCONSISTENT WITH THE PROVISIONS OF THE "CAUTIONARY STATEMENT" ABOVE OR ANY INSTRUCTIONS OR SPECIFICATIONS PROVIDED WITH OR FOR THE PRODUCT. 05/03/21 REV

Distributed by:



KURIYAMA
OF AMERICA, INC.

HEADQUARTERS, SALES OFFICE AND WAREHOUSE

360 E. State Parkway, Schaumburg, IL 60173-5335
Phone: (847) 755-0360 • Toll-free Fax: (800) 800-0320

International Fax: (847) 885-0996



kuriyama.com



sales@kuriyama.com



The trademarks contained in this publication are trademarks of Kuriyama of America, Inc.

The "Alfagomma" trademark contained in this publication is a registered trademark of Alfagomma S.p.A.

CONTACT OUR SALES/WAREHOUSE LOCATIONS BELOW WHICH SERVE YOUR AREA

SOUTHWEST WAREHOUSE

KURIYAMA OF AMERICA, INC.

– HOUSTON

200 Portwall Street, Suite 100
HOUSTON, TX 77029

Phone: (713) 674-8212

Toll Free Phone: (800) 501-6808

FAX: (713) 674-5214

Toll Free FAX: (800) 800-5214

E-Mail: sales@kuriyama.com

WESTERN WAREHOUSE

KURIYAMA OF AMERICA, INC.

– RENO

12910 Old Virginia Road, Suite 100
Reno, NV 89512

Phone: (562) 941-4507

FAX: (562) 941-8940

Toll-Free FAX: (800) 326-8940

E-Mail: sales@kuriyama.com

SOUTHEAST WAREHOUSE

FORTNEY SALES CO., INC.

4221 Cantrell Road NW
Acworth, GA 30101

Phone: (770) 427-6528

FAX: (770) 423-9249

Toll Free FAX: (800) 423-9249

Web Site: www.fortneysales.com

E-Mail: sales@fortneysales.com

EASTERN WAREHOUSE

EASTERN RUBBER & PLASTICS CO., INC.

100 GOLDMAN DR.

PLUMSTED INDUSTRIAL PARK
CREAM RIDGE, NJ 08514

Phone: (609) 758-0100

FAX: (609) 758-0102

Toll Free FAX: (800) 445-7138

Web Site: www.easternrubber.com

E-Mail: sales@easternrubber.com

IN MEXICO:

KURIYAMA DE MÉXICO S DE RL DE CV

AV JOSE PALOMO MARTINEZ NO 520-20 BODEGA 5
PARQUE INDUSTRIAL OMOLAP

APODACA, N.L. CP:66633, MÉXICO

Telefonos: (81) 1086-1870 0 71

Internet: www.kuriyama.com.mx

www.kuriyama.com

Correo Electronico: servicioalcliente@kuriyama.com