

Ground Joint

COUPLINGS & ACCESSORIES

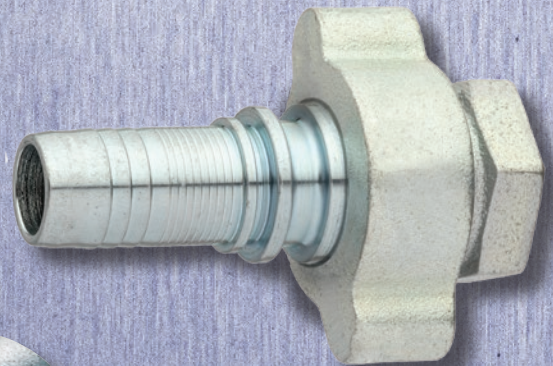

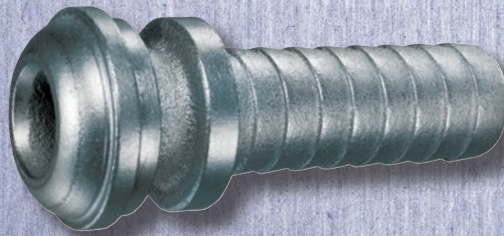

Index



AF4 222



AMNPT 223



BC2 220



BC4 221



BC6 220



DMNPT 223



GDS 219



GJ 216



GJF 218



GJM 216



GJN 217



GJS 217



GMS 218



SHF 222



SHGJ 222



WC 224



WS 224

Because we continually examine ways to improve our products, we reserve the right to alter specifications or discontinue products without prior notice.



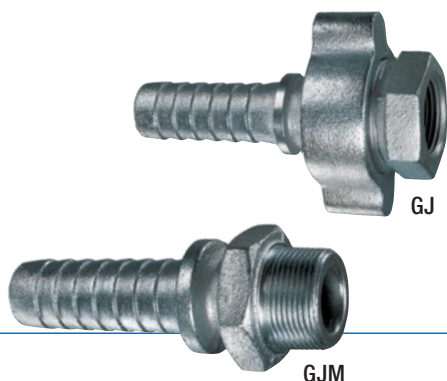

GJ Series *(Complete Set consisting of GJS, GJN, GJF)*

Hose Shank with Wing Nut and Female NPT Spud

GJM Series *(Male NPT x Hose Shank)*

Threaded Male Hose Shank

VIEW ONLINE



SCAN FOR INFO
or visit
[KOA.link/GJ-GJM](https://koya.link/GJ-GJM)

FEATURES AND ADVANTAGES

- Designed for use in medium to high-pressure applications using steam, air, and fluids.
- The metal-to-metal design provides for optimum sealing at high temperatures.
- Used in conjunction with interlocking bolt clamps.
- Couplings with hose barbs come with an interlocking collar to connect with the interlocking bolt clamps.
- Couplings with wing nut female NPS threads connect with male NPS threaded adapters known as spuds. Spuds come with multiple threaded options on the other end, and a copper seal for optimum sealing.

MATERIAL SPECIFICATIONS

- Ductile iron plated.
- ASTM A536, Grade 65/45/12.

MAXIMUM SERVICE TEMPERATURE

+450°F (+232°C)

Part Number	Size (in)	Water (psi)	Steam (psi)	Air (psi)	Weight Each (lbs)	Standard Carton
GJ-050	1/2	600	250	600	0.22	250
GJ-075	3/4	600	250	600	0.43	250
GJ-100	1	600	250	600	0.66	100
GJ-125	1 1/4	600	250	600	1.28	32
GJ-150	1 1/2	600	250	600	1.36	25
GJ-200	2	600	250	600	2.32	20
GJ-250	2 1/2	450	250	450	4.06	8
GJ-300	3	450	250	450	5.63	6
GJ-400	4	250	250	250	10.79	3
GJM-050	1/2	600	250	600	0.17	250
GJM-075	3/4	600	250	600	0.33	250
GJM-100	1	600	250	400	0.55	100
GJM-125	1 1/4	600	250	400	1.28	32
GJM-150	1 1/2	600	250	350	1.79	25
GJM-200	2	600	250	300	2.65	20
GJM-250	2 1/2	450	250	300	4.83	8
GJM-300	3	450	250	300	6.26	6
GJM-400	4	450	250	300	11.40	3

Because we continually examine ways to improve our products, we reserve the right to alter specifications or discontinue products without prior notice.

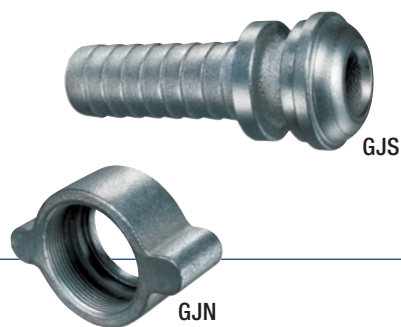

GJS Series

Hose Stem used in combination with GJN series wing nut

GJN Series

Wing Nut with NPS threads

VIEW ONLINE



SCAN FOR INFO

or visit

[KOA.link/GJS-GJN](https://koi.link/GJS-GJN)

FEATURES AND ADVANTAGES

- Designed for use in medium to high-pressure applications using steam, air, and fluids.
- The metal-to-metal design provides for optimum sealing at high temperatures.
- Used in conjunction with interlocking bolt clamps.
- Couplings with hose barbs come with an interlocking collar to connect with the interlocking bolt clamps.
- Couplings with wing nut female NPS threads connect with male NPS threaded adapters known as spuds. Spuds come with multiple threaded options on the other end, and a copper seal for optimum sealing.

MATERIAL SPECIFICATIONS

- Ductile iron plated.
- ASTM A536, Grade 65/45/12.

MAXIMUM SERVICE TEMPERATURE

+450°F (+232°C)

Part Number	Size (in)	Water (psi)	Steam (psi)	Air (psi)	Weight Each (lbs)	Standard Carton
GJS-050	1/2	600	250	600	0.18	200
GJS-075	3/4	600	250	600	0.55	100
GJS-100	1	600	250	400	0.81	100
GJS-125	1 1/4	600	250	400	1.17	32
GJS-150	1 1/2	600	250	350	1.30	35
GJS-200	2	600	250	300	1.72	25
GJS-250	2 1/2	450	250	300	3.70	10
GJS-300	3	450	250	300	4.83	8
GJS-400	4	450	250	300	8.95	4
GJN-050	1/2	600	250	600	0.31	200
GJN-075	3/4	600	250	600	0.71	60
GJN-100	1	600	250	600	0.71	60
GJN-125	1 1/4	600	250	600	1.52	40
GJN-150	1 1/2	600	250	600	1.52	40
GJN-200	2	600	250	600	2.54	24
GJN-250	2 1/2	450	250	400	4.65	10
GJN-300	3	450	250	400	5.51	10
GJN-400	4	450	250	400	10.63	4

Because we continually examine ways to improve our products, we reserve the right to alter specifications or discontinue products without prior notice.



GJF

GJF Series (Female NPT x Male NPS)

Female Spud with Copper Seal



GMS

GMS Series (Male NPT x Male NPS)

Male Spud with Copper Seal

VIEW ONLINE



SCAN FOR INFO

or visit

[KOA.link/GJF-GMS](https://koi.link/GJF-GMS)

FEATURES AND ADVANTAGES

- Designed for use in medium to high-pressure applications using steam, air, and fluids.
- The metal-to-metal design provides for optimum sealing at high temperatures.
- Used in conjunction with interlocking bolt clamps.
- Couplings with hose barbs come with an interlocking collar to connect with the interlocking bolt clamps.
- Couplings with wing nut female NPS threads connect with male NPS threaded adapters known as spuds. Spuds come with multiple threaded options on the other end, and a copper seal for optimum sealing.

MATERIAL SPECIFICATIONS

- Ductile iron plated.
- ASTM A536, Grade 65/45/12.

MAXIMUM SERVICE TEMPERATURE

+450°F (+232°C)

Part Number	Size (in)	Water (psi)	Steam (psi)	Air (psi)	Weight Each (lbs)	Standard Carton
GJF-050	1/2	600	250	600	0.29	200
GJF-075	3/4	600	250	600	0.64	100
GJF-100	1	600	250	400	0.57	100
GJF-125	1 1/4	600	250	400	1.21	40
GJF-150	1 1/2	600	250	350	1.04	40
GJF-200	2	600	250	300	1.39	32
GJF-250	2 1/2	450	250	300	4.23	12
GJF-300	3	450	250	300	5.51	10
GJF-400	4	450	250	300	8.88	5
GMS-050	1/2	600	250	600	0.29	100
GMS-075	3/4	600	250	600	0.75	60
GMS-100	1	600	250	400	0.79	50
GMS-125	1 1/4	600	250	400	1.43	30
GMS-150	1 1/2	600	250	350	1.70	30
GMS-200	2	600	250	300	2.23	30

Because we continually examine ways to improve our products, we reserve the right to alter specifications or discontinue products without prior notice.

**KOA****Couplings &
Accessories™****Ground Joint**
COUPLINGS & ACCESSORIES

GDS Series (Male NPS x Male NPS)

Double Spud with Copper Seal

VIEW ONLINE



SCAN FOR INFO
or visit
[KOA.link/GDS](https://koya.link/GDS)

FEATURES AND ADVANTAGES

- Designed for use in medium to high-pressure applications using steam, air, and fluids.
- The metal-to-metal design provides for optimum sealing at high temperatures.
- Used in conjunction with interlocking bolt clamps.
- Couplings with hose barbs come with an interlocking collar to connect with the interlocking bolt clamps.
- Couplings with wing nut female NPS threads connect with male NPS threaded adapters known as spuds. Spuds come with multiple threaded options on the other end, and a copper seal for optimum sealing.

MATERIAL SPECIFICATIONS

- Ductile iron plated.
- ASTM A536, Grade 65/45/12.

MAXIMUM SERVICE TEMPERATURE

+450°F (+232°C)

Part Number	Size (in)	Water (psi)	Steam (psi)	Air (psi)	Weight Each (lbs)	Standard Carton
GDS-050	1/2	600	250	600	0.40	100
GDS-075	3/4	600	250	600	1.32	60
GDS-100	1	600	250	400	1.32	50
GDS-125	1 1/4	600	250	400	1.41	30
GDS-150	1 1/2	600	250	350	1.41	30
GDS-200	2	600	250	300	1.92	24

Because we continually examine ways to improve our products, we reserve the right to alter specifications or discontinue products without prior notice.



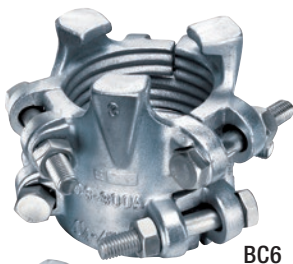

BC6

BC6 Series

6-Bolt Interlocking Hose Clamp



BC2

BC2 Series

2-Bolt Interlocking Hose Clamp

VIEW ONLINE



SCAN FOR INFO
or visit
[KOA.link/BC](https://koya.link/BC)

FEATURES AND ADVANTAGES

- Designed for use with ground joint couplings.
- Clamps are manufactured with a lip, which connects with the interlocking collar design found on the ground joint hose shank couplings.
- Clamps are available in 2, 4, and 6 bolt design, which is determined by the hose size.

MATERIAL SPECIFICATIONS

- Ductile iron plated.
- ASTM A536, Grade 65/45/12.

MAXIMUM SERVICE TEMPERATURE

+450°F (+232°C)

Part Number	Hose ID Size (in)	Clamp Size Range (in)	Weight Each (lbs)	Maximum Torque (ft lbs)	Standard Carton
BC6-300A	3	4 1/4 - 4 13/16	12.32	150	4
BC6-400A	4	4 7/8 - 5 5/16	20.30	200	2
BC6-400B	4	5 1/8 - 6 3/16	21.45	200	2

Part Number	Hose ID Size (in)	Clamp Size Range (in)	Weight Each (lbs)	Maximum Torque (ft lbs)	Standard Carton
BC2-050	1/2	13/16 - 15/16	0.31	6	100
BC2-050A	1/2	15/16 - 1 1/16	0.44	12	100
BC2-050B	1/2	1 1/16 - 1 3/16	0.48	12	100
BC2-075	3/4	1 5/32 - 1 9/32	0.73	21	60
BC2-075A	3/4	1 3/16 - 1 5/16	0.79	21	60
BC2-075B	3/4	1 5/16 - 1 1/2	0.88	21	60
BC2-075C	3/4	1 1/2 - 1 11/16	1.15	21	40

Because we continually examine ways to improve our products, we reserve the right to alter specifications or discontinue products without prior notice.



BC4 Series

4-Bolt Interlocking Hose Clamp

FEATURES AND ADVANTAGES

- Designed for use with ground joint couplings.
- Clamps are manufactured with a lip, which connects with the interlocking collar design found on the ground joint hose shank couplings.
- Clamps are available in 2, 4, and 6 bolt design, which is determined by the hose size.

MATERIAL SPECIFICATIONS

- Ductile iron plated.
- ASTM A536, Grade 65/45/12.

MAXIMUM SERVICE TEMPERATURE

+450°F (+232°C)

VIEW ONLINE



SCAN FOR INFO
or visit
KOA.link/BC

Part Number	Hose ID Size (in)	Clamp Size Range (in)	Weight Each (lbs)	Maximum Torque (ft lbs)	Standard Carton
BC4-100	1	1 17/32 - 1 23/32	1.50	21	24
BC4-100A	1	1 13/32 - 1 9/16	1.54	21	24
BC4-100B	1	1 11/16 - 1 27/32	1.68	21	24
BC4-100C	1	1 7/8 - 2 1/16	1.90	21	20
BC4-125	1 1/4	2 1/16 - 2 1/4	2.36	40	20
BC4-125A	1 1/4	1 17/32 - 1 23/32	1.79	21	20
BC4-125B	1 1/4	1 11/16 - 1 27/32	1.85	21	20
BC4-150S	1 1/2	1 13/16 - 2	2.49	40	20
BC4-150	1 1/2	2 - 2 17/32	2.40	40	20
BC4-150A	1 1/2	2 3/32 - 2 9/32	2.56	40	20
BC4-150B	1 1/2	2 1/4 - 2 7/16	2.78	40	20
BC4-150C	1 1/2	2 15/32 - 2 23/32	2.67	40	20
BC4-200	2	2 11/32 - 2 17/32	3.04	60	20
BC4-200A	2	2 1/2 - 2 25/32	2.84	60	20
BC4-200B	2	2 3/4 - 3 1/16	3.99	60	16
BC4-200C	2	3 3/32 - 3 7/16	3.97	60	14
BC4-250	2 1/2	3 1/2 - 3 15/16	6.86	150	5
BC4-300	3	3 1/2 - 3 15/16	7.45	150	5
BC4-300A	3	3 13/16 - 4 1/16	7.89	150	5
BC4-300B	3	4 1/16 - 4 7/16	10.19	200	4
BC4-300C	3	4 - 4 3/16	10.30	200	4

Because we continually examine ways to improve our products, we reserve the right to alter specifications or discontinue products without prior notice.

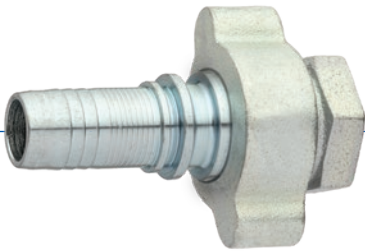

ALFAGOMMA® SHGJ Series

Female Crimp Ground Joint with Wing Nut and Female NPT Spud



VIEW ONLINE



SCAN FOR INFO
or visit
[KOA.link/SHGJ](https://koi.link/SHGJ)

FEATURES AND ADVANTAGES

- Designed for use in medium to high-pressure steam applications.
- Designed for use with Alfacomma T340, T341, & T343 series hoses.
- The metal-to-metal design provides for optimum sealing at high temperatures.
- Couplings with wing nut female NPS threads connect with male NPS threaded adapters known as spuds. Spuds come with multiple threaded options on the other end, and a copper seal for optimum sealing.

Part Number	Size (in)	Steam Crimp (psi)	Weight Each (lbs)	Standard Carton
SHGJ-CR050	1/2	270	0.75	1
SHGJ-CR075	3/4	270	1.86	1
SHGJ-CR100	1	270	1.81	1
SHGJ-CR125	1 1/4	270	3.73	1
SHGJ-CR150	1 1/2	270	3.68	1
SHGJ-CR200	2	270	5.69	1



ALFAGOMMA® AF4/SHF Series

Crimp Ferrule for use with Female Ground Joint



VIEW ONLINE



SCAN FOR INFO
or visit
[KOA.link/AF4-SHF](https://koi.link/AF4-SHF)

FEATURES AND ADVANTAGES

- Designed for use in medium to high-pressure steam applications.
- Designed for use with Alfacomma T340, T341, & T343 series hoses.
- The metal-to-metal design provides for optimum sealing at high temperatures.
- Couplings with wing nut female NPS threads connect with male NPS threaded adapters known as spuds. Spuds come with multiple threaded options on the other end, and a copper seal for optimum sealing.

Part Number	Size (in)	Steam Crimp (psi)	Weight Each (lbs)	Standard Carton
AF4-08	1/2	270	0.18	1
SHF-12	3/4	270	0.24	1
SHF-16	1	270	0.46	1
SHF-20	1 1/4	270	0.54	1
SHF-24	1 1/2	270	0.76	1
SHF-32	2	270	1.16	1

Because we continually examine ways to improve our products, we reserve the right to alter specifications or discontinue products without prior notice.

**KOA****Couplings &
Accessories™****Ground Joint**
COUPLINGS & ACCESSORIES**ALFAGOMMA®****AMNPT/DMNPT Series****One-Piece Male Crimp NPT Fitting****VIEW ONLINE****SCAN FOR INFO***or visit***KOA.link/DMNPT****FEATURES AND ADVANTAGES**

- Designed for use in medium to high-pressure steam applications.
- Designed for use with Alfagomma T340, T341, & T343 series hoses.
- The metal-to-metal design provides for optimum sealing at high temperatures.
- Couplings with wing nut female NPS threads connect with male NPS threaded adapters known as spuds. Spuds come with multiple threaded options on the other end, and a copper seal for optimum sealing.

Part Number	Size (in)	Steam Crimp (psi)	Weight Each (lbs)	Standard Carton
A-0808-MNPT	1/2	270	0.31	1
D-1212-MNPT	3/4	270	0.50	1
D-1616-MNPT	1	270	0.96	1
D-2020-MNPT	1 1/4	270	1.40	1
D-2424-MNPT	1 1/2	270	2.01	1
D-3232-MNPT	2	270	2.84	1

Because we continually examine ways to improve our products, we reserve the right to alter specifications or discontinue products without prior notice.



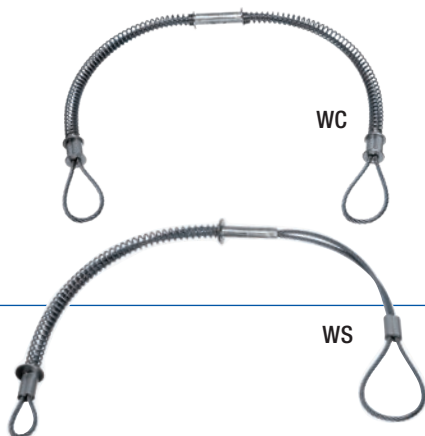

WC Series

Hose-to-Hose Service

WS Series

Hose-to-Tool Service

VIEW ONLINE



SCAN FOR INFO
or visit

**KOA.link/HOSE-
SAFETY**

FEATURES AND ADVANTAGES

- Designed for use in air and steam applications.
- Safety cables minimize damage when there is an accidental separation of an assembly.
- Safety cables reach across the hose fittings providing a safety standby when used on assemblies.
- Spring-loaded loops on the ends of the cables open easily over the fittings or tools providing a firm grip on the hose.

MATERIAL SPECIFICATIONS

- Wire Rods – Carbon Steel AISI(SAE) 1064.
- Crimp Material – ASTM B 221, Grade Aluminum 6063-T6.
- Spring – Carbon Steel ASTM A29, Grade 1060.
- Washer – Carbon Steel ASTM A29, Grade 1008.

Part Number	Hose ID Range (in)	Size (in)	Pressure Rating (psi)	Length (in)	Weight Each (lbs)	Standard Carton
WC-1	1/2 - 1 1/4	1/8	200	24	0.24	200
WC-2	1 1/2 - 3	1/4	200	38	1.15	50
WS-1	1/2 - 1 1/4	1/8	200	20	0.17	200
WS-2	1 1/2 - 3	1/4	200	38	0.95	50

VIEW OUR FULL LINE OF
STEAM HOSE & ACCESSORIES
AT
KOA.LINK/STEAM



Because we continually examine ways to improve our products, we reserve the right to alter specifications or discontinue products without prior notice.